

INHABITING THE SURROUNDS: URBANITY, CRITIQUE AND SPECULATIVE PRACTICE

URBAN STUDIES SUMMER SCHOOL

23-26 SEPTEMBER 2024, TURIN

2-6 JUNE 2025, LISBON

program



The event is funded by the ERC Inhabiting Radical Housing project (n. 851940).

It is also supported by DIST (Polytechnic and University of Turin), DINAMIA'CET-ISCTE (Lisbon University Institute), and the ICS (University of Lisbon).

What does it mean to think around habitation and its struggles, in a world where every inch of the possible seems to have been colonised by the extractive and expulsive makings of racial, financial capitalism? How to assemble, and engage with, radical modalities of use-value concerning the staples of habitation – addressing housing (in)justice, the expansion of computation, the emergent multiplicity of entities forming ever-complex ecologies, to reimagine a sense of the future in the midst of a planetary crisis? How to re-approach a critique to dwelling praxis grounding it within the generative force of what AbdouMaliq Simone has named the surrounds, “a shape-shifting matrix of spaces, times, and practices that exist right now within the turbulent processes of contemporary urbanization”?

We are interested in establishing a conversation with engaged scholars tackling these questions in a number of transdisciplinary ways, and, in particular, we are keen to hear from those who transcend the remit of conventional ‘comparative’ urban approaches, and those who go beyond the rubric of liberal, Western literatures and approaches to understand geographies of struggles in a situated and politically relevant way. Grounded in the ‘collective study’ methodology of the Beyond Inhabitation Lab, and fostered by the long-standing critical tradition of urban thinking adopted by the Urban Transitions Hub, we have joined forces to provide a platform for thinking and exchange around these themes, in the form of a double-event School located in two Southern European cities (Turin and Lisbon).

rationalale

Workshops and presentations will be @sala Mollino

9:30 10:00	Arrival and Registration
10:00 11:00	Introduction by Convenors <i>Michele Lancione, AbdouMaliq Simone, Andrea Pavoni, Irene Peano</i>
11:00 12:00	Meet the Beyond Inhabitation Lab
12:00 13:00	Introduction of Postdoctoral fellows
13:00 14:30	<i>Lunch @ Sala Colonne</i> and a coffee with Progetto Palestina on students-led activism for Palestine in Turin
14:30 17:00	Workshop session with Tatiana Thieme
	<i>Break</i>
18:00 19:30	Public Keynote MOVING THROUGH ENTROPIC TIMES: RUBBLE, REFUSAL, AND REGENERATION Tatiana Thieme @ Salone d'Onore
20:00	<i>Dinner @ Casa del Quartiere</i>

23sept

MOVING THROUGH ENTROPIC TIMES: RUBBLE, REFUSAL, AND REGENERATION

Tatiana Thieme

It feels impossible not to be consumed with melancholia, outrage and disappointment in the face of overlapping injustices, violence, and frightening political and ecological collapse everywhere one looks. How then do we hold onto a modicum of hope as we navigate the classroom, our field-sites, and reflect on the meaning of what we do? This talk builds on a piece written during the Covid-19 pandemic, "Beyond Repair: Staying with Break-down at the interstices". Here, I reflect on what it means to move through the break-down, to think about the generative moves that work with entropic times of disorder and uncertainty. I ground the discussion by reflecting on recent events in Nairobi, Kenya, that echo wider politics of climate injustice and urban removal, political uprising, and quiet ecological encroachments. This rebel city brings together outrage, joyful militancy, and a hustle urbanism that is underpinned by a politics of hope and collective struggle amidst the breakdown; a politics that we could think with as we try to grapple with entropic times and trouble elsewhere.

Tatiana Thieme is an urban ethnographer and Associate Professor based at University College London in the Department of Geography. Tatiana draws together her training in dance, anthropology, and geography (from Cornell University, LSE, and University of Cambridge) to study the social, economic, ecological and cultural lives of young people navigating precarious urban environments. Tatiana's primary field-site is Nairobi, Kenya, where she has been conducting on-going research in popular neighbourhoods since 2009. Her secondary field-sites are Paris and Berlin where she has worked on grassroots migrant solidarities since 2017, and London where she has studied the porosity of carceral spaces. She has published in various journals and has a forthcoming monograph (Spring 2025), titled *Hustle Urbanism: Making Life Work in Nairobi*, with University of Minnesota Press.

keynote

Workshops and presentations will be @sala Mollino

10:00
12:30 Workshop session with Ruth Wilson Gilmore

13:00
14:30 *Lunch @ Sala Colonne* and a coffee with Irene Peano on
CPR (Migration Detention Centres)

14:30
17:00 Post-Doc presentations
coordinated by Devra Waldman

Break

18:00
19:30 Public Keynote
ABOLITION AS METHOD
Ruth Wilson Gilmore
@Salone d'Onore

24sept

presentations 24/09

Theo Barry Born

Department of Urban Studies and Planning, University of Sheffield

Nitin Bathla

Department of Architecture, ETH Zürich

Kamile Batur

Institute of Art and Design, TU Wien

Rebecca Choi

School of Architecture, Tulane University

Megnaa Mehtta

Institute of Risk and Disaster Reduction, University College London

postdocs

ABOLITION AS METHOD

Ruth Gilmore

To find our way through the densities of the surrounds, where do we begin? Anywhere. Where might we go? That would depend on our guide to action. In this lecture I will develop some thinking shaped by Lenin, Cabral, and social reproduction theorists such as Battacharya to propose how methodological approaches might tend toward emancipatory place-making across many sites and scaled of social reality's "surrounds."

Ruth Wilson Gilmore is Professor of Earth & Environmental Sciences, American Studies, and Africana Studies at the City University of New York Graduate Center. Co-founder of many grassroots organizations, Gilmore is author of *Abolition Geography: Essays Towards Liberation* (Verso), and *Golden Gulag: Prisons, Surplus, Crisis, and Opposition in Globalizing California* (University of California Press). She and Paul Gilroy edited *Stuart Hall: Selected Writings on Race and Difference* (Duke University Press). *Change Everything* is forthcoming from Haymarket. The Antipode documentary *Racial Capitalism* with Ruth Wilson Gilmore features her internationalist work. Gilmore has lectured in Africa, Asia, Europe, and North America. Honors include the 2020 Lannan Foundation Lifetime Cultural Freedom Prize (with Mike Davis and Angela Y. Davis), and the 2022 Marguerite Casey Freedom Scholar Prize. She is a member of the American Academy of Arts and Science.

keynote

Workshops and presentations will be @sala Mollino

10:00
12:30 Workshop session with Alana Osbourne

13:00
14:30 *Lunch @ Sala Colonne* and a coffee with Cambiare Rotta
on students-led anti-militarisation actions in Turin

14:30
17:00 Post-Doc presentations
coordinated by Devra Waldman

Break

18:00
19:30 *Public Keynote*
IM/POSSIBLE CONVIVIALITY: THINKING THROUGH
ROCKS, ARCHIVES AND IMPERIAL CONTINUITIES.
Alana Osbourne
@Salone d'Onore

25sept

presentations 25/09

Dalia Gebrial

Department of Geography, King's College London

Katharina Grueneis

School of Geography, University of Nottingham

Ingy Higazy

Global Affairs and Public Policy (GAPP) and the Middle East Studies Center, The American University in Cairo

Irmelin Joelsson

Department Of Social Anthropology, Norwegian University Of Science And Technology

Mariz Kelada

Europe in the Middle East (EUME), Forum Transregionale Studien

postdocs

IM/POSSIBLE CONVIVIALITY: THINKING THROUGH ROCKS, ARCHIVES AND IMPERIAL CONTINUITIES.

Alana Osbourne

Departing from a small rock found in my family archives, in this lecture, I trace the colonial continuities that connect inorganic matter to the past and the future of cities like Brussels. In so doing, I ask: how do relations between rocks and blackness shape the im/possibility of convivial inhabitation in the post-colonial city?

Alana Osbourne's work is located at the intersection of anthropology, heritage studies and black geographies, and is concerned with forms urban violence and racialized inequities. She has carried out fieldwork in Jamaica and Belgium and currently works on two projects that probe how urbanites work through the material and affective manifestations of coloniality. The first project focuses on Brussels, where she observes how official parliamentary assemblies and grassroots tourism initiatives variously work issues of race and memory into - and through - the city. The other project traces the colonial entanglements of museums, inorganic matter and outer-space travel in three European cities. Alana co-convenes a yearly symposium series and edits an attendant publication on colonial audio-visual archives called Inward Outward. She teaches Critical Theory at Radboud University.

keynote

Workshops and presentations will be @sala Mollino

10:00 Post-Doc presentations
12:30 coordinated by Devra Waldman

13:00 *Working Lunch - Next steps and wrap up*
14:30

26sept

presentations 26/09

Killian O'Dochartaigh

Edinburgh College of Art, Edinburgh University
Architectural Field Office

Victoria Ogoegbunam Okoye

School of GeoSciences, University of Edinburgh

Anne-Marie Veillette

Africana Studies Department, University of Pennsylvania

Julia Wagner

Department of Earth & Environment, Boston University

Darien Alexander Williams

Macro Practice Department, Boston University

postdocs

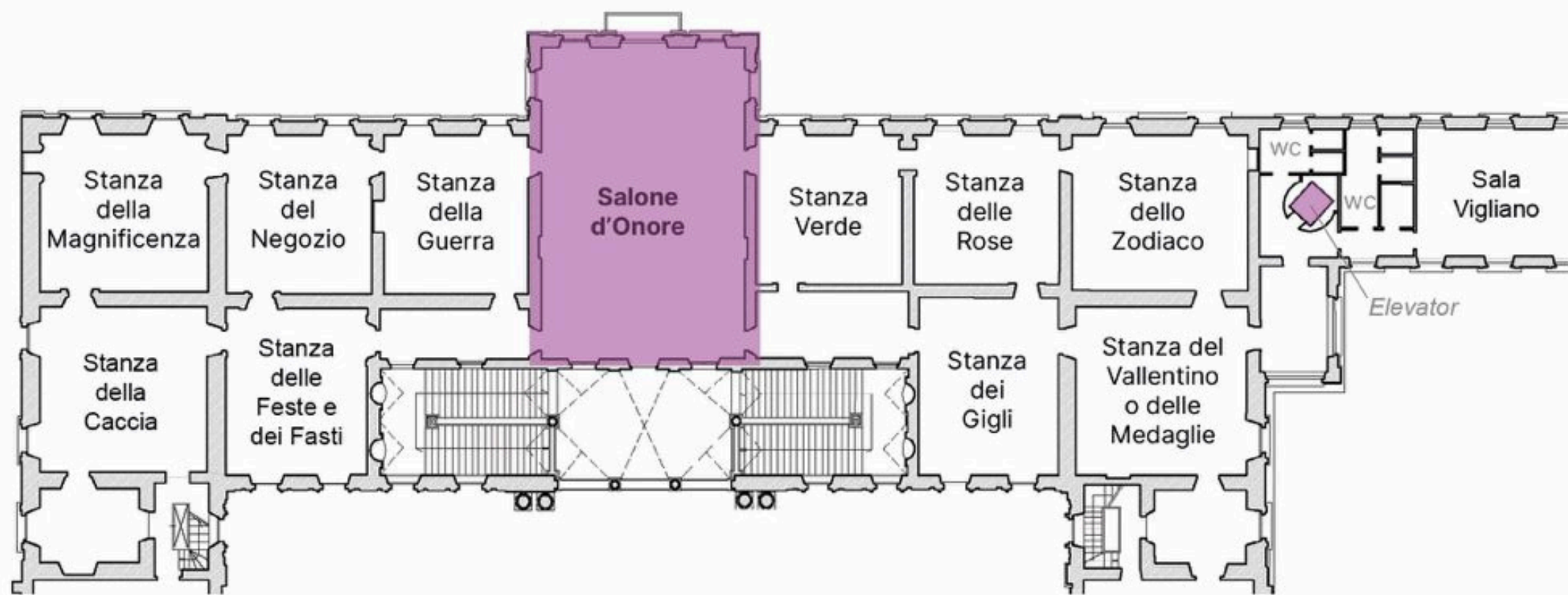
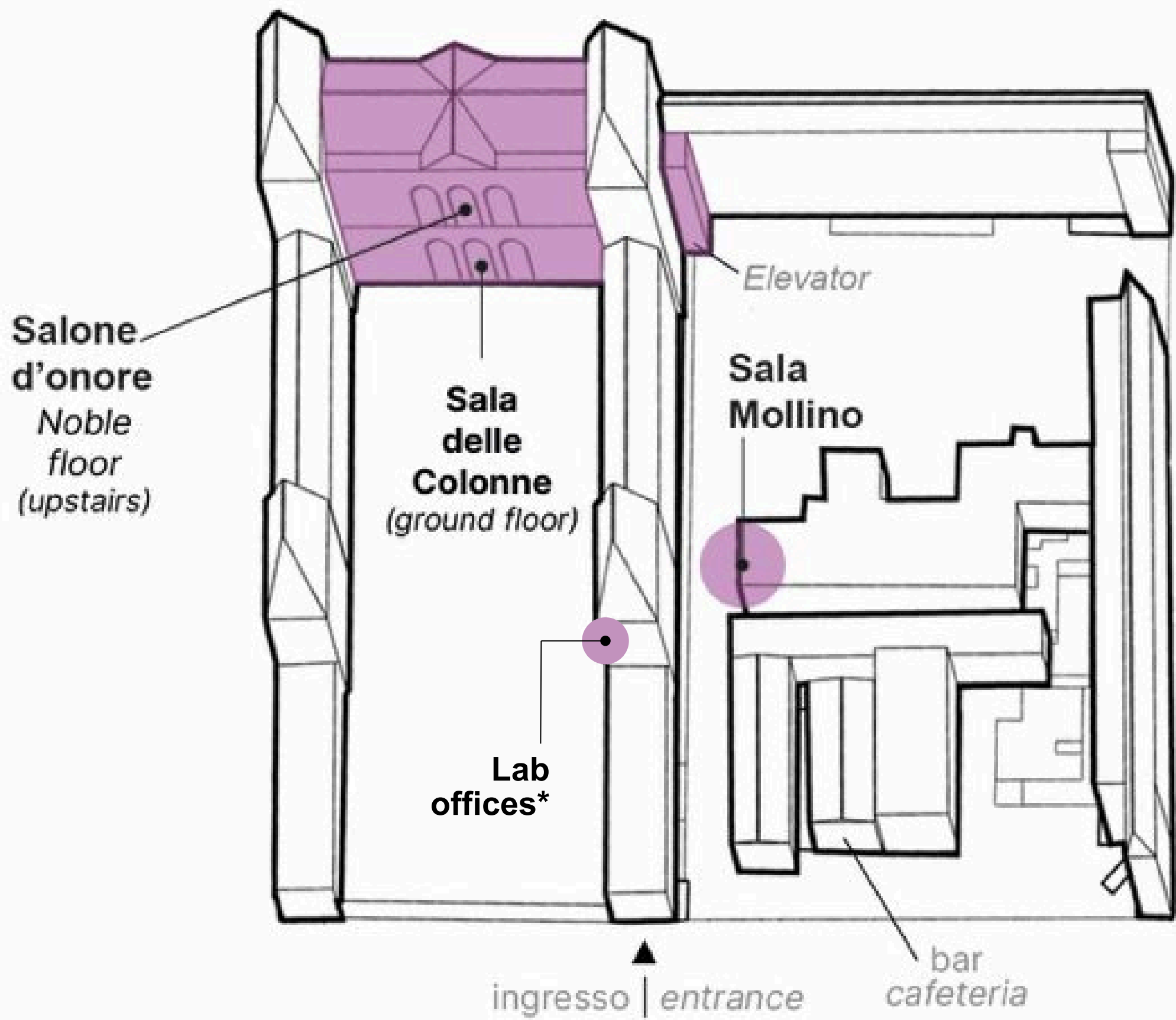

*If anybody needs quite working space you can use Lab offices

maps

Convenors

Michele Lancione, *Beyond Inhabitation Lab*

AbdouMaliq Simone, *Beyond Inhabitation Lab*

Andrea Pavoni, *Urban Transitions Hub*

Irene Peano, *Urban Transitions Hub*

Writing coordinators

Mara Ferreri, *Beyond Inhabitation Lab*

Francesca Governa, *Beyond Inhabitation Lab*

Marco Allegra, *Urban Transitions Hub*

Lavinia Pereira, *Urban Transitions Hub*

organizers

Beyond Inhabitation Lab

Interuniversity Department of Regional and Urban Studies and
Planning Politecnico di Torino

Michele Lancione

michele.lancione@polito.it

AbdouMaliq Simone

a.t.simone@sheffield.ac.uk

Silvia Aru

silvia.aru@unito.it

Chiara Cacciotti

chiara.cacciotti@polito.it

Mara Ferreri

mara.ferreri@polito.it

Chiara Iacovone

chiara.iacovone@polito.it

Daniela Morpurgo

daniela.morpurgo@polito.it

Devra Waldman

dwaldman@fsu.edu

For any emergencies you can contact Michele:

+39 3473808741

Local committee

thank you